



**2022**

# B&B FOODPAK

---

FOOD PROCESSING  
KNIVES & PARTS

**Your one stop supplier** for  
food processing & packaging  
replacement parts

[www.bbfoodpak.com](http://www.bbfoodpak.com)

**YOUR ONE  
— STOP —  
SUPPLIER**

# Welcome to our Product Catalog

## Your One Stop Supplier

B&B Foodpak specialise in the supply of machine knives and replacement parts for the Food and Packaging Industries.

We have an extensive range of spare parts. This includes knives and some machine parts for grinding, slicing and thermo packaging machines.

Compare our quality and price for VALUE!

## Our guarantee

We guarantee the quality of our products. If product is faulty we will replace or refund your money. Claims on faulty or damaged product must be lodged within 14 days of receipt of goods.

*All orders are subject to B&B Foodpak's Payment Terms and Recovery Policy. Please contact us to obtain a copy of these Terms and Conditions.*

*DISCLAIMER: \*Brand names and trademarks published herein are registered trademarks of their respective companies. Birk & Blyme Foodpak (B&B Foodpak) has no association or affiliation with these companies. All mentioned spare parts are alternative parts to those of the OEM. B&B Foodpak supply compatible high quality replacement parts. All indicated reference numbers are only used for identification purposes.*

## At B&B Foodpak we offer:

- A wide range of quality products
- Fast delivery service
- Helpful friendly service
- 30 Day accounts subject to approved account applicants.

## We accept:



# Contents

<b>4</b>	<b>25</b>
<b>MINCER/EMULSIFIER KNIVES &amp; PLATES</b>	<b>FISH &amp; POULTRY PROCESSING</b>
<b>13</b>	<b>27</b>
<b>SEPARATION</b>	<b>PACKAGING</b>
<b>15</b>	<b>34</b>
<b>FILLING</b>	<b>SUCTION CUPS</b>
<b>17</b>	<b>35</b>
<b>INJECTING</b>	<b>VACUUM PUMPS</b>
<b>18</b>	<b>38</b>
<b>CUTTING</b>	<b>LABELLING</b>





# Grinding Hole Plates

## ENTERPRISE SYSTEM

No. 12, 22, 32, 52, 56 & 66  
Plates available in **Tool Steel**, **INOX** and **D2**.  
1.5 mm to 25 mm (1/16" - 1")



## UNGER SYSTEM

D114, E130, F150, G160, U200, FW200, WK200, V250, WK250, K280, W300 & X400



## WEILER STYLE PLATES

6", 7", 8", 11" & 16"

### WEILER PLATES INSIDE DIAMETERS:

- 1 1/4"
- 2", 2 1/8"
- 3", 3 1/4", 3 1/2"
- 4"
- 6", 6 1/2"

Center bore style threaded or keyway. Bone Collection plates.



## EXELSIOR / VELATI SYSTEM

150, 180, 200, 220 & 250

Outside Ø mm	Inside Ø mm
150	22.6
180	28.6
200	33
220	33
250	33

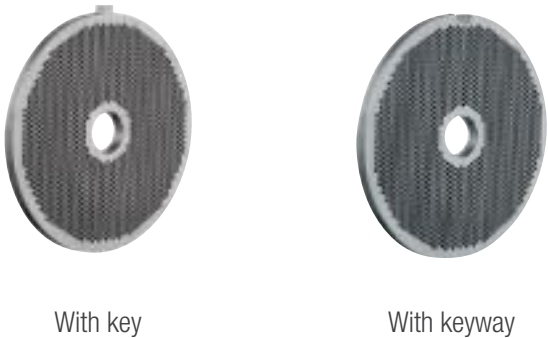

# Grinding Hole Plates

## FILLING MACHINES

130 mm

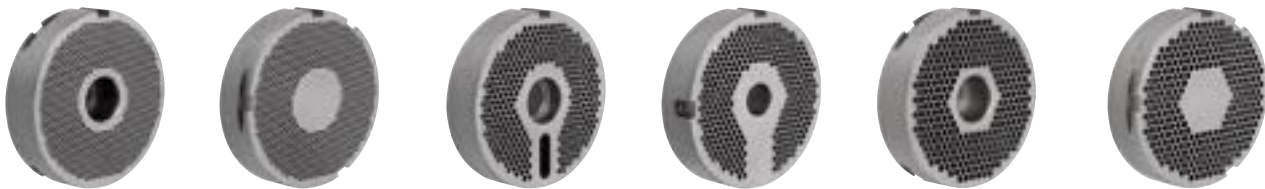

## PORTION CONTROL PLATES

For Filling Grinders like Handtmann™ and Vemag™

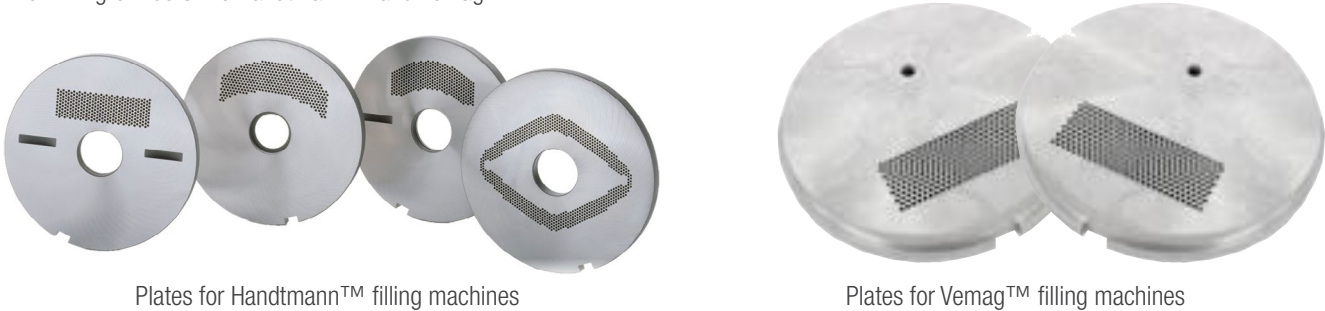

## EMULSIFIER PLATES

Available in **Tool Steel** or **INOX**.  
Standard sizes Ø 150, 175, 200, 225, 248 and 320 mm.  
Hole sizes from 0.5mm to 35mm.

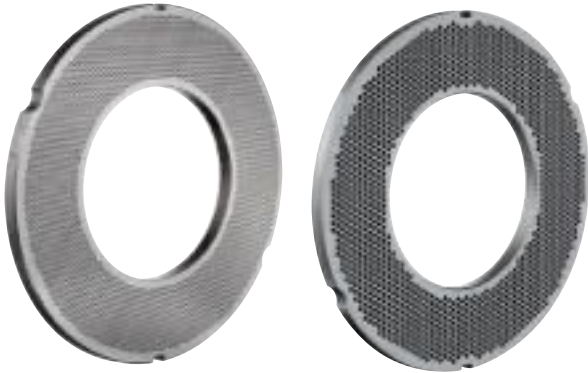

## KONTI-KUTTER™ PLATES

TO SUIT SEYDELMANN®

**Stationary Rings & Spacers** S-20, S-30, S-60, S-90, S-120, S-144, S-250 and S-350

**Rotating Rings** R-10, R-20, R-60, R90, R-120, R-144, R-250, R-350, R-400 and R-420

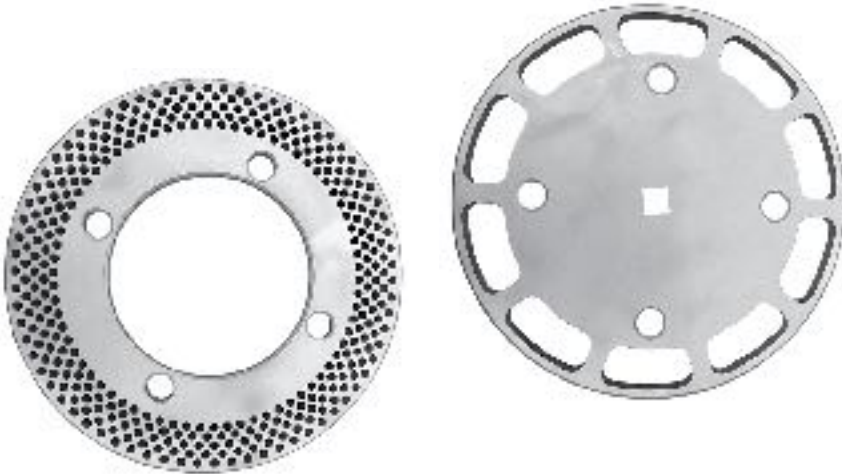

## Grinding Knives



Robot 4 arm

Robot 4 arm w/ring.  
*Available as fixed or loose*

4 arm single cut



4 arm double cut



4 arm strong - SY



4 arm curved



6 arm straight serrated



"Garant" 4,6 or 8 arm



Robot 6 arm

Robot 6 arm w/ring.  
*Available as fixed or loose*

6 arm curved



8 arm curved



Robot 8 arm

Robot 8 arm w/ring.  
*Available as fixed or loose*

3 arm Propellor



4 arm "Buffalo"



6 arm sickle ring



8 arm sickle ring

### CAN'T FIND YOUR KNIFE OR PLATE?

Please call us with details and we can quote you.  
These pages are for guidance only and do not include  
all available Knives & Plates.

## Grinding Knives & holders



6 arm ring knife



8 arm ring knife



10 arm ring knife



3/3 ring knife



4/4 ring knife

4/4 ring knife.  
*Available as fixed or loose*

6/6 Ring Knife



8/8 Ring Knife



6 arm sorting knife TC2



4 arm sorting knife K&amp;G



Knife Holder 4 arm for screw in insert blades



Knife Holder 4 &amp; 6 arm for profile insert blades

WK225 Knife holder.  
*Also available as 3 arm*

4 arm Velati Knife Holder



Weiler type Knives



Clip on Enterprise Style



# Grinding Precutters & Spacers



3 hole diamond  
Available straight or inclined



3 hole thick straight



3 Hole thick inclined



3 hole kidney fixed



3 hole sickle



3 hole with fastening chamfers



5 hole straight



5 hole with grooves



5 hole angled grooved



5 hole kidney



6 hole Vemag™



7 hole thick 80mm ID



7 hole kidney fixed



7 hole kidney loose



9 hole kidney fixed



Plastic slide bearing.  
Detectable.

## SPACERS

Distance rings available in normal tool steel and INOX (stainless). Common sizes listed below. Other sizes available upon request.

	E130	G160	U200	K280
Small	28mm	35mm	45mm	40mm
Wide	55mm	66mm	84mm	60mm



Fixed/stepped



Fastening chamfer

# Grinding Inserts

- Floating & Fixed style emulsifier inserts
- Popular sizes stocked
- Precision ground

For machines of well-known manufacturers such as \*K&S®, Wolfking®, Simo®, Velati®, CFS/GEA®, Weiler®, and Seydelmann® etc.



No#	OEM #	PART NUMBER	Insert length
1	108-1155	AD103076	5-3/8"
2	108-1411	AD111628	5"
3	108-2440	AD102982	4-1/16"
4	108-2450	AD104699	3-63/64"
5	108-1154	AD106465	3-3/4"
6	108-1991	AD105066	3"
7	108-2448	AD105493	2-7/8"
8	108-1458	AD106415	2-5/8"
9	108-1972	AD102350	1-7/8"



## WOLFKING® STYLE



## KS 175 & 225 STYLE



## SIMO® STYLE



## Grinding Parts

### SUPPORT STARS

For E130, G160, U200, K280 & W300



STEEL BEARING



BLUE PLASTIC DETECTABLE



3 spoke with or without bearing.  
4 & 5 spokes also available

### WORM PINS



### AUGERS

To suit Wolfking™, GEA™, CFS™, Simo™ and Weiler™

Quality augers for Wolfking™, Weiler™, CFS™, GEA™, Simo™ and Weiler™ grinders.

Most models are available in both Stainless Steel and Normal Steel.

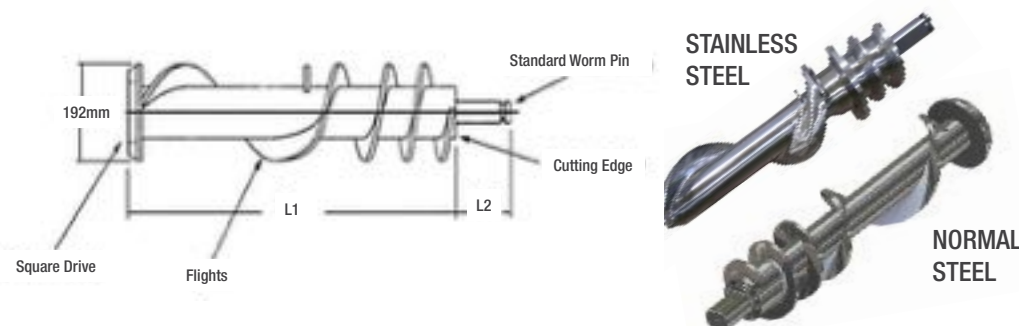

### PILOT BEARINGS, BUSHINGS AND D-NUTS

To suit \*Wolfking®, CFS®, GEA®

PILOT BEARING C250 UNI\*



PILOT BEARING C400 UNI\*

BUSHING



PILOT ROLLER BEARING



KNIFE HOUSING



D NUT



## Pump Parts

### DRIVE HUB & IMPELLERS



### PUMP HOUSING



### CONTIFLOW® (CFD) PARTS



Bushing (rear hub)  
314354/30673



Bushing (front hub)  
314352/30672



### WEAR RINGS

Suction gate ref 35545  
Pressure gate ref 35765 (not pictured)



Bushing (pressure gate)  
30379



Bushing (pressure gate)  
30381



AD37697 set 4 pcs



AD37696 (pair)

### HANDTMANN ROTOR & VANES





## Emulsifier Cutting Systems

TIPPER TIE®, STEPHAN®, BUSSER®, KARL SCHNELL®, FOOD-TEC®

### HIGH PERFORMANCE CUTTING SYSTEM

(M-C10 to MCHD 100)

- No friction heat & wear
- Longer tool life
- Reduced pressure

**HIGH  
PERFORMANCE  
SYSTEM**



### INSERT BLADES



### CUTTING RING

1.3 mm gap



### CUTTING RING

0.9 mm gap



### CUTTING HEAD

58 mm -18 teeth



### CUTTING HEAD

38 mm -18 teeth



## Separation – MDM

### SEPERATOR BELTS



#### THERMOPLASTIC PU (FX)

Each available for the outside and running side.

- Thermoplastic PU (FX) in 80 Shore A
- Thermoplastic PU (FX) in 90 Shore A

#### PRODUCT DIMENSIONS:

Length 1300 - 3000 mm

Width 150 - 300 mm

Thickness 10 - 14 mm



#### VARIANTS

Does your preparation process involve separating meat from bones, cartilage, tendons or feathers?

We can offer you different variants of belts for both drive and chain driven equipment.

### MDM PARTS SUCH AS AUGERS, SCREENS, VALVES, SLEEVES ETC.

To suit Beehive®, Poss®, Sepamatic®, Lima, AM2C



Screens made  
to OEM SPECS  
or CUSTOMISED  
to order

# Separation TO SUIT LIMA® AND AM2C®

## LIMA® SEPARATORS

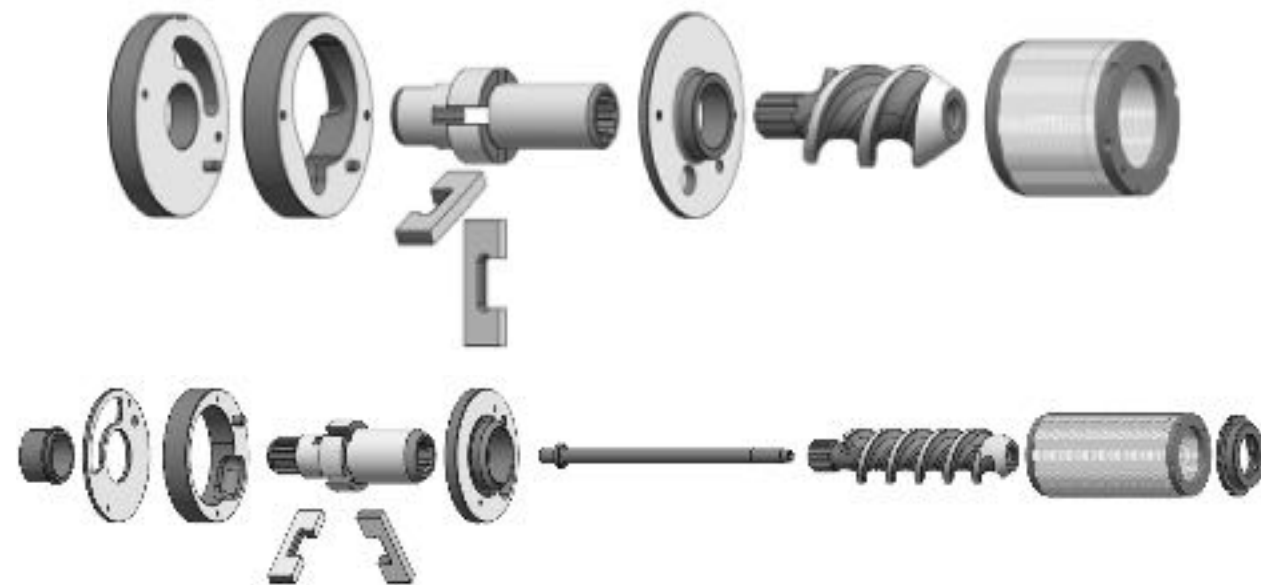

## AM2C® SEPARATORS

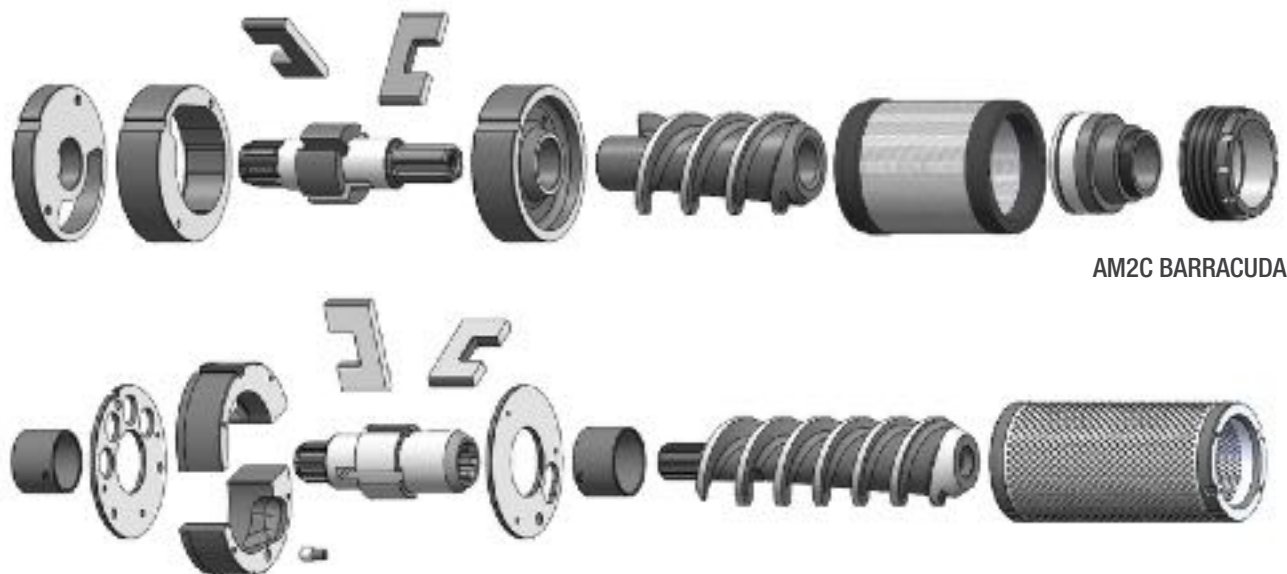

AM2C BARRACUDA

German made separator tools to optimise your raw materials. Maximum efficiency when used with poultry, beef, pork and fish – you also achieve exceptional results when separating fat and rind. Also for fruit and vegetable products to maximise yield. Augers and wedge wire screens for many common machine types such as Lima® & Am2c® and many more. It doesn't always have to be the original!

- Made entirely of stainless steel
- Hardened wedge wire screens
- All Augers milled
- Material and hardness according to customer requirements “hickey”

**SAVE ON  
OEM COSTS**

It doesn't always have  
to be the original!

# Linker & Peeler Parts

## REPLACEMENT PARTS FOR LINKERS & PEELERS

We are proud to supply a great range of products, including:

- Linking Chains
- Linker Heads
- Gears
- Vacuum & Feed Wheels
- Twisting Chucks
- Peeler Knives
- etc



PEELER BLADES

### CHAIN SERIES:

“C” series = 14-22mm of product

“S” series = 19-27mm of product

“L” series = 24-36mm of product



LINKING CHAINS AND LINKER HEADS



LINKER HEAD



FEED WHEEL



TWISTING CHUCKS



SPROCKETS



PUMP HOUSING



STUFFING TUBES



HANDTMANN NOZZLES



# Portioning

## HANDTMANN® HOLDER



BB-10406

## HANDTMANN® KNIFE

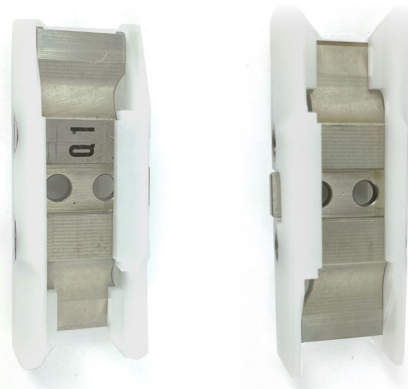

BB-10407

## MORE PORTIONING KNIVES



Marel® BB-9337



Marel® BB-8012



Marelec® BB-10198



Marelec® BB-9702



TVI® BB-10196



Vemag® BB-12561



Vemag® BB-12562

# Injector Needles

WE OFFER INJECTOR NEEDLES FOR MOST MEAT INJECTOR MODELS, INCLUDING:

- Fomaco®
- Günther®
- Belam®
- Garos®
- Metalquimia®
- Inject Star®
- Suhner®
- Schröder®
- Rühle®
- Lutetia®

And MUCH more...

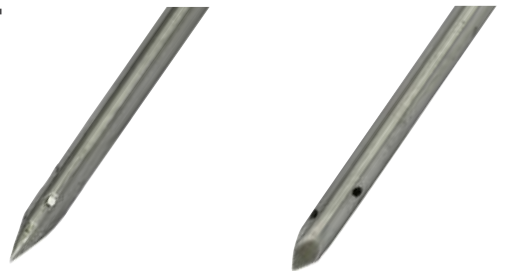

Bullet Point

Triangular Point

## FOMACO\* STYLE



## \*GÜNTHER, SUHNER, INJECT STAR, BELAM STYLE



Many other types available. Please contact us for a quote.



ACCESSORIES

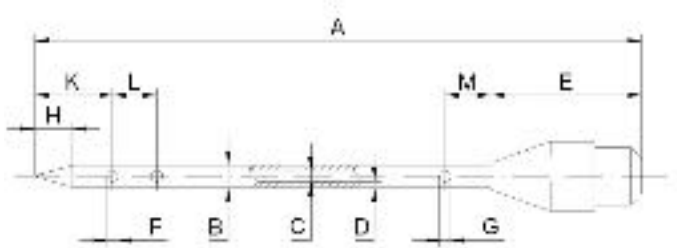

# Slicing Involute & Circular

## SLICER BLADES

Slicer blades for machines of well-known manufacturers, such as \*Weber®, Formax®, Schindler & Wagner®, Thurne®, Treif®, GEA/CFS®, Natec®, Berkel®, Hobart®, Omas®, Titan® and etc.

The product range includes various custom types of serration and edge geometries (straight, convex, concave, fine and special serration) as well as different non-stick coatings for a variety of applications.

- Hard Chromed
- Teflon Coated

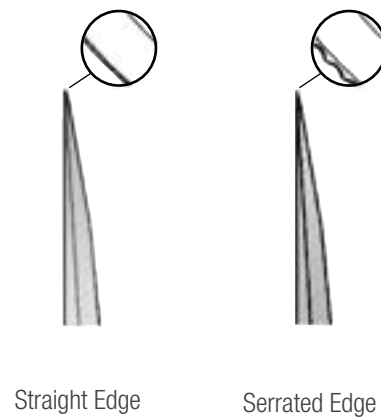

Straight Edge

Serrated Edge

## INVOLUTE BLADES



## CIRCULAR BLADES



## VARIOUS TYPES OF SERRATED EDGES AVAILABLE



## SLICING ACCESSORIES

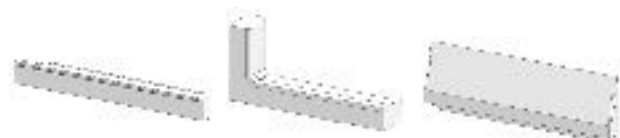

Plastic wedges



Cutting stick

## GRINDING DISCS



# Bowl Chopper Blades

## BOWL CUTTER BLADES

Made of special high quality rust-resistant steel.

For Bowl Cutters made by \*Alpina®, Kilia®, Krämer & Grebe®, Laska®, Seydelmann® and other well known manufacturers.

Blades also available for systems, such as Delta®, Securit® or Feuring®.

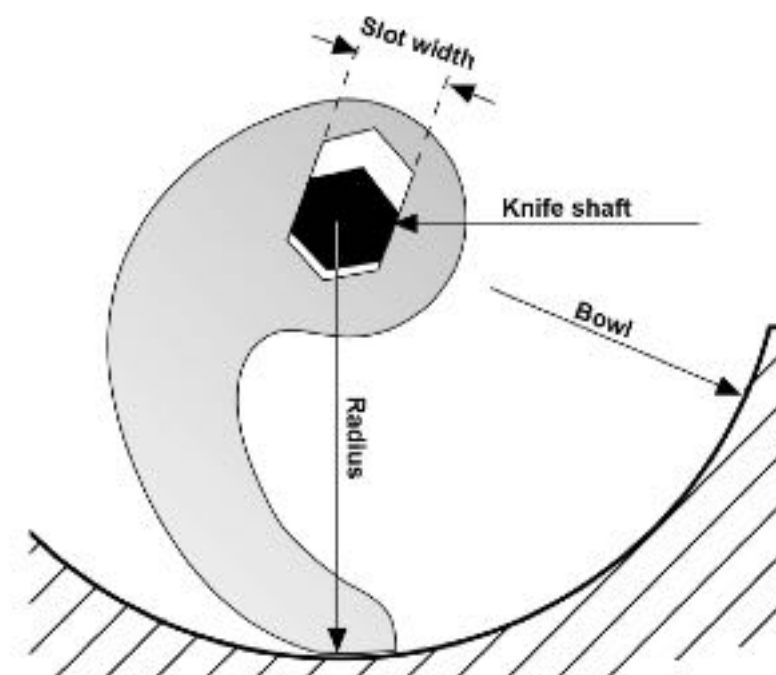

## HOW TO ORDER

- 1) Make and Model of machine.
- 2) Bowl capacity in litres.
- 3) Radius of knife. Distance from shaft centre to bottom bowl.
- 4) Slot dimensions.



## Various Blades

### FROZEN FOOD BLADES

- For Frozen Cutters made by Laska®, Magurit®, Nagema®, Rühle® etc.

Available in different types as Flaker Blades, Guillotine Blades.

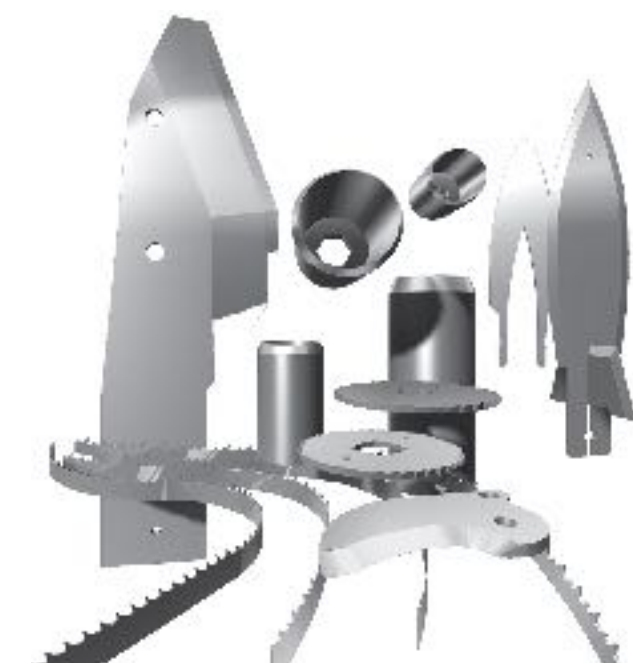

### SLAUGHTERING BLADES

Band Saw Blades, Circular Saw Blades, Debleeders and Vent Cutters etc.

Circular Bone Saw Blades to suit EFA® and Freund®. Standard and Carbide tipped available in a variety of teeth configurations.



### TAPE SEAL KNIVES

Case Seal Knives to suit 3M® and SIAT® type equipment.



## Various Blades

### CHOPPER BLADES

Blade types for machines such as Holac®, Treif®, Rühle®, TVI® and Carruthers® etc.

- Special applications can be manufactured to customers requirements.
- Different edge types and coatings are possible.

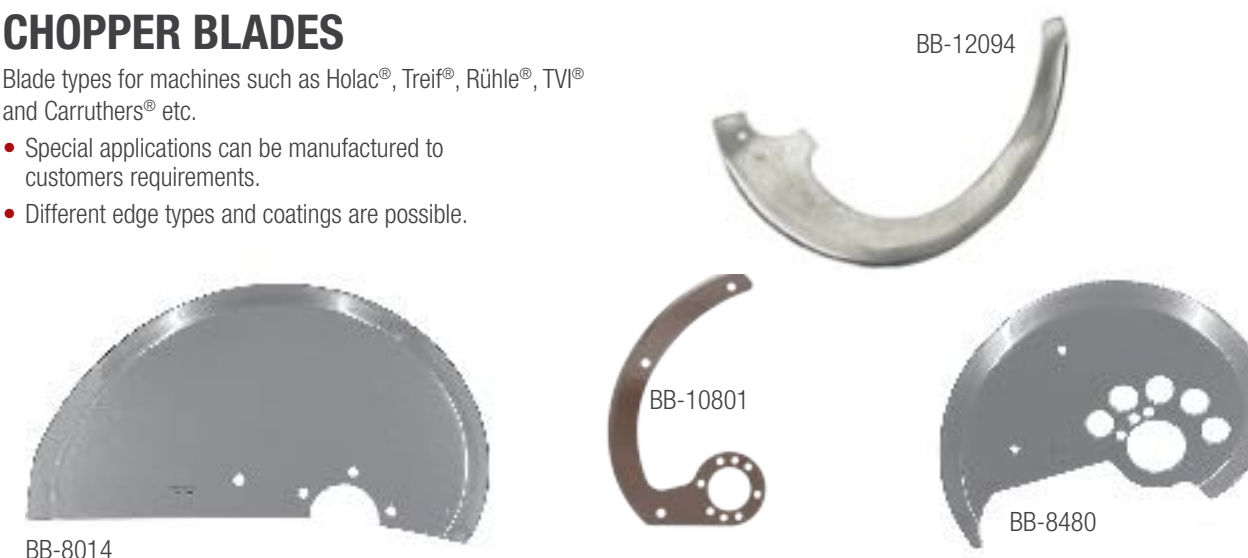

### VEGETABLE CUTTERS

Blade types for machines such as Urschel®, FAM®, Carruthers®, Kronen® and Carruthers® etc.

- Special applications can be manufactured to customers requirements.
- Different edge types and coatings are possible.

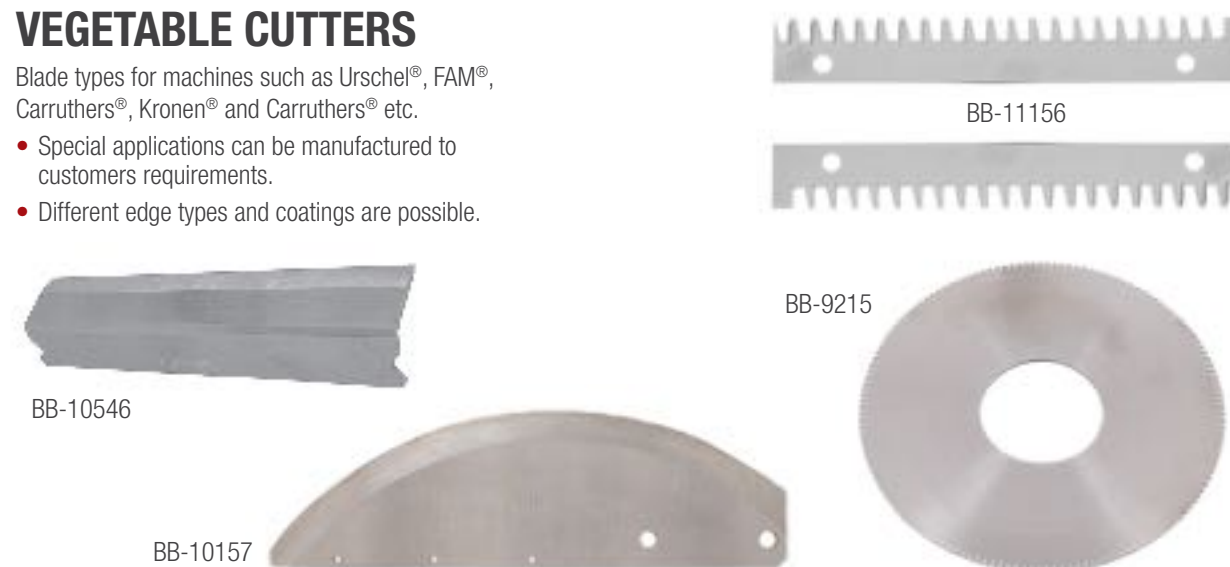

### TENDERIZER BLADES (MACERATOR)

Blade types for machines such as Nu Meat®, Günther®, Danfotech®, and Metalquimia® etc.

- We can supply to all machine models and to specific customers requirements.



# Skinner Blades

- For machines of well-known manufacturers such as Maja®, Townsend®, Weber®, Cretel® and Grasselli® etc.
- Made of stainless steel with square or tapered edge.
- CALL US FOR A COMPETITIVE QUOTE!

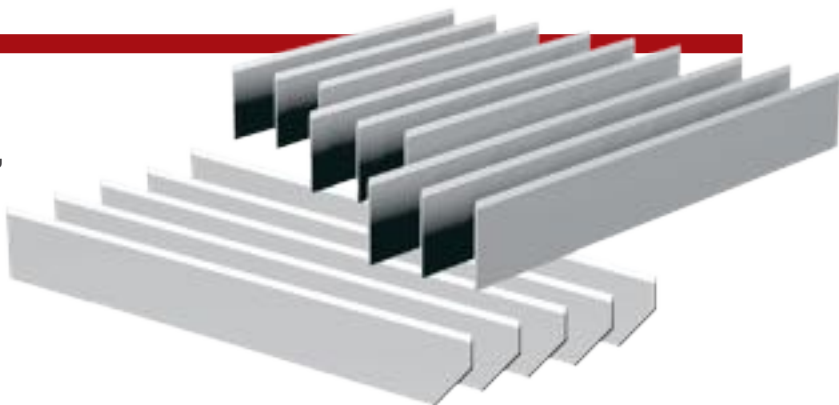

PLASTIC SLEEVES FOR EASY STORAGE & HANDLING



45° TAPERED EDGE BLADES



90° SQUARE EDGE BLADES



## SKINNER TOOTH ROLLERS

Precision quality machined tooth skinner/rollers specially designed for use on skinning machines.  
Various machines brands available with short delivery times.



Common sizes	Manufactures
297 x 20 x 1 mm	Maja
434 x 20 x 1 mm	Maja
499 x 20 x 1 mm	Maja
554 x 20 x 1 mm	Maja
599 x 20 x 1 mm	Maja
699 x 20 x 1 mm	Maja
799 x 20 x 1 mm	Maja
450 x 10 x 0.5 mm	Grasselli
450 x 16 x 1 mm	Grasselli
450 x 16 x 0.5 mm	Grasselli
520 x 20 x 1 mm	Grasselli
350 x 22 x 0.7 mm	Grasselli
450 x 22 x 0.7 mm	Grasselli
500 x 22 x 0.7 mm	Grasselli
520 x 22 x 0.7 mm	Grasselli
365 x 22 x 0.7 mm	Townsend
400 x 22 x 0.7 mm	Townsend
430 x 22 x 0.7 mm	Townsend
445 x 22 x 0.7 mm	Townsend
468 x 22 x 0.7 mm	Townsend
472 x 22 x 0.7 mm	Townsend
518 x 22 x 0.7 mm. 45°	Townsend
580 x 22 x 0.7 mm	Townsend
397 x 20 x 1 mm	Weber
460 x 20 x 1 mm	Weber
497 x 20 x 1 mm	Weber
593 x 20 x 1 mm	Weber
720 x 20 x 1 mm	Weber
397 x 22 x 0.7 mm	Weber
497 x 22 x 0.7 mm	Weber
359 x 20 x 1 mm	Cretel
460 x 22 x 0.7 mm	Cretel

# Grid / Dicer Blades

TREIF Dimensions of Common Types \*\*

BBFP Part #	Dimensions (mm) (L x H x T)"	Type *	Treif # (where known)
BB-10222	182 x 8.5 x 0.5		21937
BB-9820	182 x 8.5 x 0.75		
BB-10022	182 x 12 x 0.5	SV neg.	81398
BB-9597	182 x 12 x 0.75	SV neg.	58752
BB-8690	182 x 14 x 0.75	Serrated	
BB-8578	182 x 14 x 1.0		
BB-10023	182 x 16 x 0.5	SH pos.	81397
BB-9598	182 x 16 x 0.75	SH pos.	58751
BB-8353	182 x 16 x 1.0		13312
BB-9166	182 x 16 x 1.0	Serrated	13326
BB-8354	182 x 16 x 1.5		13313
BB-2071	237.5 x 13 x 0.5	w/ rivets	
BB-8871	237.5 x 13 x 0.7	w/ rivets	177936
BB-8873	237.5 x 13 x 1.0	w/ rivets	161578
BB-9153	237 x 10 x 0.5		
BB-8870	250.5 x 22 x 1.5		15391
BB-9148	250 x 22 x 1.0		15390
BB-10060	260 x 24 x 2.0		
BB-9899	265 x 13 x 0.5		
BB-8078	265 x 13 x 0.75		89340
BB-8121	265 x 13 x 1.0		40233
BB-8988	266 x 22 x 0.75		
BB-8074	266 x 22 x 1.0		14607
BB-9898	266 x 22 x 1.0	Serrated	14663
BB-9514	266 x 22 x 1.5		14608
BB-12138	266 x 22 x 2.5		
BB-12139	311 x 27 x 1.0		
BB-12140	311 x 27 x 1.5		
BB-2070	362 x 13 x 0.5	w/ rivets	
BB-8872	362 x 13 x 0.7	w/ rivets	177937
BB-10795	362 x 13 x 1.0	w/ rivets	161577
BB-10834	424.5 x 10 x 0.5	w/ rivets	Zebra

\* Blades are Stainless Steel; Standard Shape; Smooth Blade; with Holes for Mounting - unless otherwise indicated  
\*\* Other sizes and brands available. \*\* Please enquire

## HOW TO ORDER

- Please specify by order or enquiry:
- 1) Type of Blade
  - 2) Length x Height x Thickness (L x H x T)
  - 3) Machine Name
  - 4) Tooth Pitch on scalloped blades (P)
  - 5) Center to center distance rivets (R)

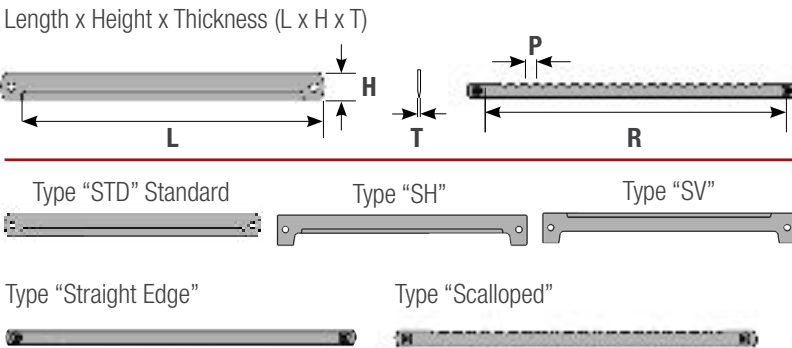



# Grid / Dicer Blades

## HOLAC Dimensions of Common Types \*\*

BBFP Part #	Dimensions (mm) (L x H x T)"	Type *	Holac # (where known)
BB-8084	196 x 18 x 1.0		31-1175-0
BB-9410	196 x 18 x 1.5		31-1178-0
BB-12444	196 x 18 x 1.0	SV	31-1198-0
BB-12445	196 x 18 x 1.0	SH	31-1192-0
BB-10588	246 x 20 x 1.0 SH	SH pos.	
BB-10589	246 x 20 x 1.0 SV	SV neg.	
BB-8122	270 x 25 x 1.0		16-0181-1
BB-8177	270 x 25 x 1.0 SH	SH pos.	
BB-8176	270 x 25 x 1.0 SV	SV neg.	16-0190-1
BB-8740	270 x 25 x 1.5		16-0182-1
BB-9715	270 x 25 x 1.5	Serrated	16-0186-1
BB-9373	270 x 25 x 2.5		16-0184-1
BB-12146	270 x 30 x 1.5		
BB-12147	270 x 30 x 1.5	Serrated P=7 mm	
BB-8284	270 x 30 x 2.0		
BB-8285	270 x 30 x 2.0	Serrated	
BB-8508	270 x 30 x 2.5	Serrated	
BB-8289	270 x 30 x 3.0		
BB-8290	270 x 30 x 3.0	Serrated	

\* Blades are Stainless Steel; Standard Shape; Smooth Blade; with Holes for Mounting - unless otherwise indicated

## FOODLOGISTIK Dimensions of Common Types \*\*

BBFP Part #	Dimensions (mm) (L x H x T)"	Type *	Holac # (where known)
BB-11148	234 x 10 x 1		
BB-10109	238 x 20 x 1	4 mm Wide Bevel	
BB-8025	238 x 20 x 1	6 mm Wide Bevel	
BB-10105	238 x 20 x 1	Serrated P=7 mm	
BB-10227	238 x 20 x 1	Serrated P=12 mm	
BB-10228	238 x 20 x 1	Serrated P=13 mm	

\* Blades are Stainless Steel; Standard Shape; Smooth Blade; with Holes for Mounting - unless otherwise indicated

\*\* Other sizes and brands available. \*\* Please enquire

### HOW TO ORDER

Please specify by order or enquiry:

- 1) Type of Blade
- 2) Length x Height x Thickness (L x H x T)
- 3) Machine Name
- 4) Tooth Pitch on scalloped blades (P)
- 5) Center to center distance rivets (R)

Length x Height x Thickness (L x H x T)

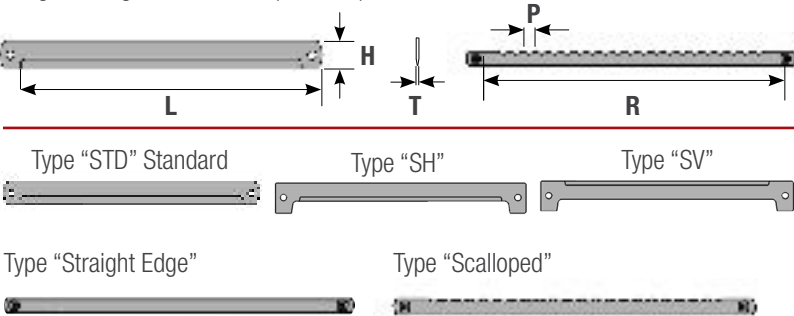

# Poultry Blades

## CIRCULAR BLADES

Full range of Circular Blades to Suit Stork™, MEYN™, Systemate™ and Baader™.

- Serrated
- Micro-Tooth
- Plain slitters

Blades available in stainless steel and various tool steels.

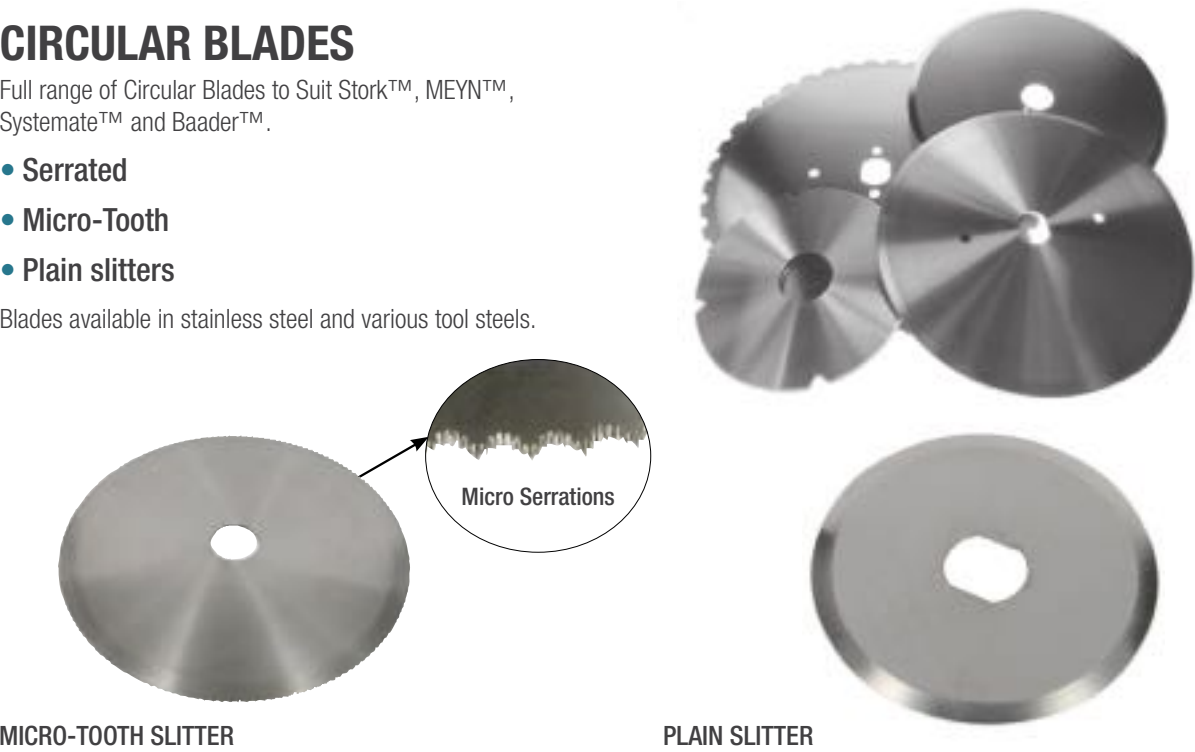

## PROCESSING BLADES

Various flat knives for cut up systems:



Many other blade types available.  
**CALL US FOR FULL DETAILS!**

# Parts For Gizzard Harvesters

## PEELER ROLLERS



## BEARING BLOCKS



## PINCH OFF ROLLERS



## EJECTION WHEELS



## SPIRAL GUT GEARS



**NOT SURE WHAT YOU ARE  
LOOKING FOR?**

Give us a call on 02 9452 0222 and our sales  
team can help you figure it out!

# Packaging

## PUNCHES

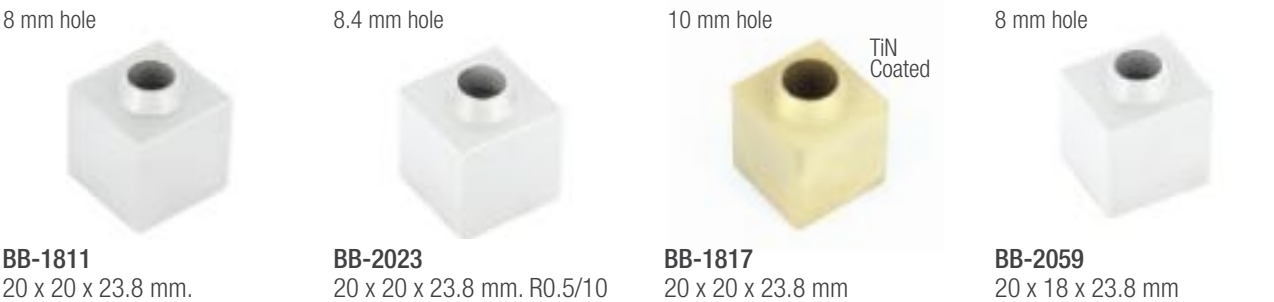



# Packaging Knives

## PUNCH CUT & PERF BLADES



• Supplied to required length • PERFS: Specify cut and tie ratio • Height 23.7 or 23.8 mm  
**CARBIDE\*** and TiN Coated blades available on request (\*Thick Cut blades only)

## CAPPED NEOPRENE SPACERS



**COMMON SIZES**  
143 x 23.7 x 5 mm, 147 x 23.8 x 8.65 mm  
174.5 x 23.8 x 8.65 mm and 500 x 17 x 7.5 mm

## ANVIL CUTTING BLOCK

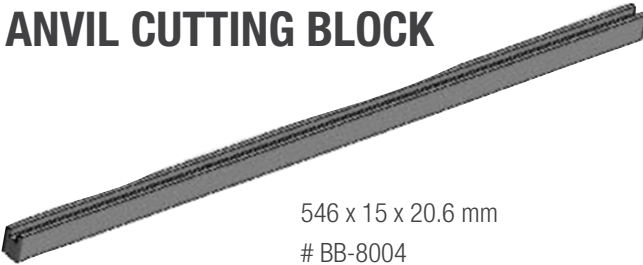

546 x 15 x 20.6 mm  
# BB-8004

## GAS NOZZLES

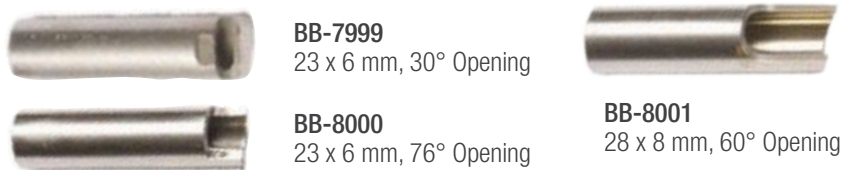

**BB-7999**  
23 x 6 mm, 30° Opening

**BB-8000**  
23 x 6 mm, 76° Opening

**BB-8001**  
28 x 8 mm, 60° Opening

# BB-7998, 23 x 6 mm (not pictured)



**Vee Knife** 35 x 20 x 6 mm  
# BB-7997

## GRIPPER CHAINS

Available for most Thermoforming machines.

- **Carbon Steel Nickel Plated.** Through hardened. Good corrosion resistance. Excellent strength and wear resistance.
- **Austenitic Stainless Steel.** Cr-Ni austenitic stainless steel. AISI 302-304 (1.4301). Excellent corrosion resistance.



## SUNDRIES

- Suction Grabbers
- Pump filters and vanes.



**MORE FOR VACUUM PUMP FILTER & VANES**  
See pages 35-37

# Packaging Knives

## CIRCULAR BLADES



**SPLIT VERSION**  
**90 x 42 x 2 mm - MV**  
Double Bevel = BB-1549  
Single Bevel = BB-1550

**SOLID VERSION**  
**90 x 42 x 2 mm - MV**  
Double Bevel = BB-1753

**90 x 42 x 2 mm - MV**  
Double Bevel = BB-1927  
Single Bevel = BB-7994



**150 x 42 x 2 mm - MV**  
Double Bevel = BB-7699

**DISHED SLITTER - MV**  
**102 x 70 mm** = BB-1547  
**105 x 70 mm** = BB-1548  
**105 x 65 mm** = BB-9812 (TM)

**90 x 42 x 1 mm**  
Double Bevel = BB-1912D2  
To suit Variovac\*



**80 x 30 mm - TM**  
Slitter = BB-7995  
Slitter with "V" Slots = BB-7996

**77 x 19 x 5.2 mm - MV**  
Squeezing knife = W13-00-30  
\*Perf 4.5 mm:0.8 = W13-05  
(\*or as per your requirements)

**SQUEEZING KNIFE HOLDER**  
BB-10529  
OEM ref 11.551.9173.00



**Slitter Holder - MV**  
BB-9255  
For Slitters BB-1549 & BB-1550

**Slitter Holder - MV**  
BB-2206 = 45mm  
BB-2235 = 35mm  
For Slitters BB-1547 & BB-1548

**Bottom Cutters (Anvil) - MV**  
Ø 170 mm = BB-1622  
Ø 368 mm = BB-1638  
Ø 288 mm = BB-1637

# Packaging Knives

## CROSS CUT OFF BLADES

Available for most Thermoforming machines.

- **Stainless Steel**
- **TiN Coating available on request**

WIDE RANGE  
AVAILABLE.  
CONTACT US FOR  
PRICE AND  
AVAILABILITY.



**BB-1551**  
415mm to suit Cryovac®



**BB-1620**  
405mm to suit Multivac®



**BB-1659**  
285mm to suit Multivac®



**BB-1878**  
385 mm to suit Multivac®



**BB-8774**  
385mm to suit Tiromat®



**BB-10042**  
391mm to suit Ulma®

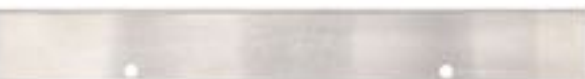

**BB-10115**  
320mm to suit Multivac®



**BB-12472**  
405 mm to suit Variovac®



**BB-9235**  
525mm to suit Multivac®



**BB-8894**  
445 mm to suit Multivac®

# Packaging Knives

## TOOTHED KNIVES

Available for most Packaging machines.



**TOOTHED CUTTER**  
BB-7662  
Cryovac®



**TOOTHED KNIFE**  
BB-2156  
Bosch



**TOOTHED KNIFE**  
BB-1593  
Cryovac®



**TOOTHED KNIFE**  
BB-10317  
ULMA

## VARIOUS BLADES

Available for most Thermoforming machines. Including, but not limited to:

- **Piercing Blades**
- **Snip-Snap Blades**
- **Contour Blades**

Wide range available. Please contact us for price and availability.



**PIERCING BLADES**  
BB-8882

**CONTOUR BLADES**

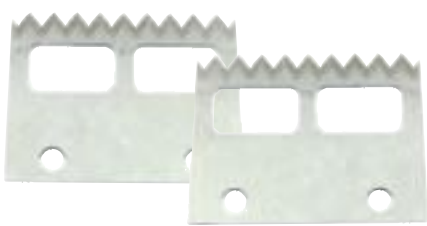

**SNIP-SNAP BLADES**  
BB-1859



**MV FLY KNIFE**  
BB-9061



**COMPLETE PIERCING BLADE JIG - CV**  
BB-7884



BB-9948 (90mm)



BB-10221 (74mm)



# Packaging Knives

## TRAY SEAL KNIVES

Tray Knives available for most types and models of sealing machines, including \*CFS®, Mondini®, Ross®, Proseal® and Multivac® etc.

All types available, including with or without lugs. Single, Twin, Triple and 4 cell trays.

Our Tray Seal knives are supplied with knife protection guards and are skin packed to provide transport and handling protection.



WITH FLANGE

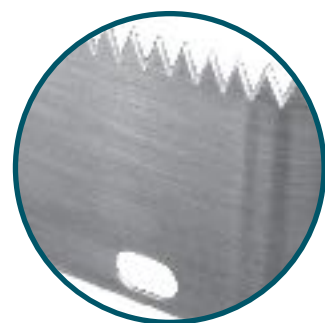

WITH SLOTS

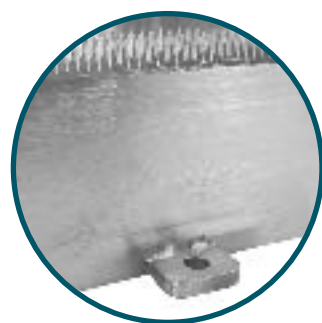

WITH LUGS TYPE A

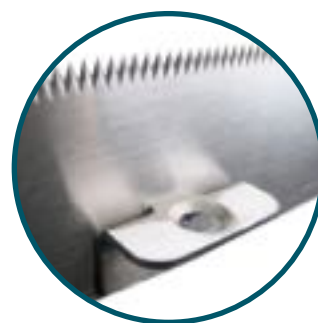

WITH LUGS TYPE B

# Packaging seals

## SEALING GASKETS

Sealing Gaskets supplied in premium quality Silicone. Made according to your sample or drawings.

Red "T" profile strip seals available in your required lengths.

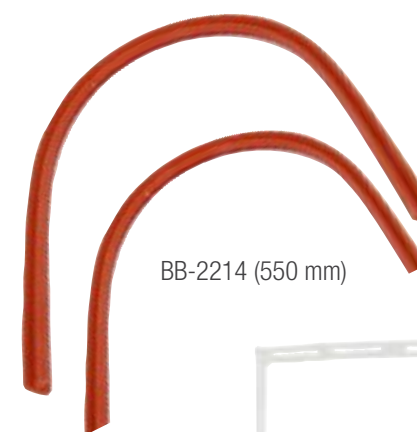

BB-2214 (550 mm)



## VARIOUS MULTIVAC™ SPARE PARTS

Gripper chains, sprockets, bearings, springs, filters, shafts, teflon tape, support rails, relays, breakers, valves, regulators, gauges, pressure switches, bladders, pneumatic diaphragm and much more.



# Suction Cups

## VACUUM CUPS FOR PACKAGING AND MORE.....

We supply vacuum cups for many different packaging machines, robotics, parts handling and other industrial handling machinery. We have over 1000 different vacuum cups, with a variety of fittings and styles. We supply cups in rubber, vinyl, silicone, polyurethane, neoprene, and other materials.

*Please send a sample or drawing for us to identify your vacuum cup.*

- Canning
- Box Making
- Cartoning & Bagging
- Filling & Sealing
- Capping
- Pick and Place
- Labeling
- Machinery Automation
- Tray Making



# Vacuum Pumps Replacement Parts

TO SUIT BUSCH™, RIETSCHLE™, BECKER AND MANN™

## AIR FILTERS

Model: BUSCH™, RIETSCHLE™, BECKER and MANN™



## EXHAUST FILTERS

Model: BUSCH™, RIETSCHLE™, BECKER and MANN™



## CARBON VANES

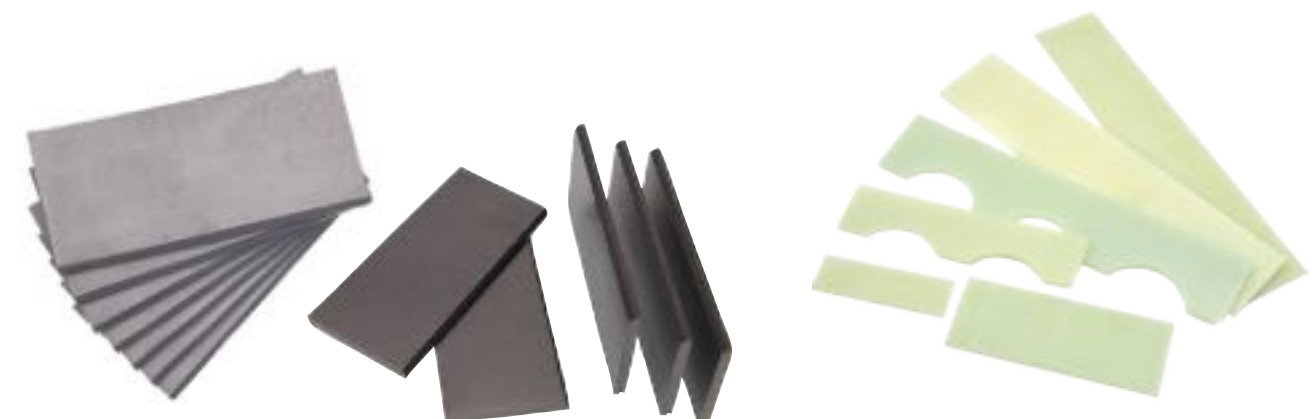



# Vacuum Pumps Replacement Parts

## RIETSCHLE PUMP VANES

OEM Ref No	Model	Qty/pump
507107	CLFT-41-DV	8
507108	CLFT-61-all	8
507109	CLFT-81-DV	8
507110	CLFT-101-DV	8
524142	CLFT-141-DV	8
518943	KTA-40-all / TR-41all	6
523777	KTA-60-all	6
523778	KTA-80/1,2,3,4	6
524436	KTA-80/5	8
523889	KTA-100	6
523885	KTA-140	6
513431	TR-26-all	7
515642	TR-61-all	7
514870	TR-81-all	7

## ORION PUMP VANES

OEM Ref No	Model	Qty/pump
04009564010	KRX3 / CBX15	4
04009565010	KRX5 / CBX25	4
04041811011*	KRX6	4
04012865010°	KRS7A (old) thin	4
04012865010ª	KRS7A (new) thick	4
04007480010	KRA8	6
04009564010	CBX15 (2-KRX3)	8
04009565010	CBX25 (2-KRX5)	8
04041811011*	CBX40 (2-KRX6)	8
04012865010	CBX61 (2-KRXA)(old)	8
04039395010	CBX61 (2-KRXA)(new)	4

\*Vanes Old# 0400456601 ° KRS7A takes old vanes  
ª KRS7D OR KRX 7D takes new vanes

## BECKER PUMP VANES

OEM Ref No	Model	Qty/pump
90132900	DVT2.60	8
90133000	DVT3.60, DVT3.80, DVT3.100	7
90133000	DVT2.80, DVT2.100	8
90133400	DVT2.140/3.140	7
90133200	T16DS	8
90130800	T25DS	8
90133100	T40DS	7
90134700	T.316DSK	7
90134900	T.325/4.25 DSK	7
90135200	T.340/4.40 DSK	7
90137200	T.360DSK	7

## BUSCH PUMP VANES

OEM Ref No	Model	Qty/pump	BB Part #
722.000.270	RA/RC.0025	3	BUV-25
722.000.300	RA/RC.0040	3	BUV-40
722.000.330	RA/RC.0063	3	BUV-63
722.000.360	RA/RC.0100	3	BUV-100
722.000.452	RA/RC.0160B	3	BUV-160B
722.000.454	RA/RC.0400	3	BUV-400
722.000.455	RA/RC.0630	3	BUV-630
722.000.456	RA.1000	3	BUV-1000
722.515.895	RA/RC.0012, 0021	3	BUV-12/21
722.516.054	RA/RC.0502B	3	BUV-502B
722.516.573	RA/RC.0160-205, C/D	3	BUV-160/205
722.516.729	RA/RC.0250/305/B/C/D	3	BUV-250/305
722.000.016	SV 1063 B / DC 0063	4 / 7	BUV-1063B
722.000.017	SV 1080 B / DC 0080	4 / 7	BUV-1080B
722.000.189	SV 1025 B	7	BUV-1025B
722.000.242	SV 1010 B	7	BUV-1010B
722.000.489	SV 1016 B&C	7	BUV-1016BC
722.500.050	SV 1140 C / DC 0140C	4 / 8	BUV-1140C
722.500.122	SV 1100 C / DC 0100	4 / 8	BUV-1100C
722.510.168	SV 1250 A	4	BUV-1250A
722.533.535	SV 1010 C	7	BUV-1010C
722.533.536	SV 1025 C	7	BUV-1025C
722.534.079	SV 1040 B&C	7	BUV-1040BC



PLEASE CALL US FOR VANES NOT LISTED ABOVE

# Vacuum Pumps Replacement Parts

## POPULAR FILTERS



BB Part No	OEM Ref No	Pump	Description
BB-2976	96540400	Becker	Exhaust Filter
BB-2718	96541500	Becker	Exhaust Filter
BB-12625	731904	Rietschle	Air Filter
BB-2757	532006000	Busch	Air Filter
BB-9849	532000003	Busch	Air Filter
BB-10316	532000005	Busch	Air Filter
BB-2719	532000007	Busch	Air Filter
BB-3014	532500045	Busch	Air Filter
BB-3015	532500046	Busch	Air Filter
BB-3016	532500047	Busch	Air Filter
BB-2735	532000002	Busch	Air Filter (C1112)
BB-2736	531000004	Busch	Air Filter K2050)

BB Part No	OEM Ref No	Pump	Description
BB-10004	532140155	Busch	Exhaust Filter
BB-2702	532140156	Busch	Exhaust Filter
BB-2701	532140157	Busch	Exhaust Filter
BB-9716	532140160	Busch	Exhaust Filter
BB-12770	992573694	Busch	Exhaust Filter
BB-2704	531000001	Busch	Oil Filter
BB-2703	531000002	Busch	Oil Filter
BB-2705	531000005	Busch	Oil Filter
BB-9730	80421201601	Domnick Hunter	Filter Element
BB-12927	4000451010	Orion	Air Filter
C713/1	731142	Rietschle	Air Filter (C713/1)
C717/1	731143	Rietschle	Air Filter (C717/1)

## TIMING BELTS FOR VFFS MACHINES

To suit BOSCH, CFS aquarius, Rovem, TNA and Ishida

### COATINGS

- Polyurethane yellow
- Polyurethane + Silicone light yellow
- Natural rubber red
- Silicone blue



LEFT HAND



STRAIGHT



RIGHT HAND

OEM  
Manufactured  
in Europe.

# Thermal Print Heads

Genuine Thermal Print Heads produced by Rohm Semiconductor and Kyocera®. For all types of printers available on the market: Berkel®, Bizerba®, Datamax®, Digi®, Markem-Imaje®, Avery Denison®, Toshiba-Tec®, CAB®, Zebra® and other leading brands

- Clear printing
- No smearing
- Competitive pricing



TPH0066 - Avery Denison® 300DPI



TPH0226 Markem-Imaje® 300DPI



TPH0008 - Bizerba® 200DPI



TPH0003 - Bizerba® 200DPI



TPH00057 - CAB® 300DPI



TPH0282 - Bizerba® - 200DPI



TPH0042 - Intermec® 200DPI



TPH0232 - Datamax® 200DPI



TPH0237 - Datamax® 200DPI



## BELTS AND PLATEN ROLLERS



SEND US  
YOUR MODEL FOR  
A QUICK QUOTE!

# Labelling Accessories



TPH9961 BB-10911 TPH9918 TPH9821

Reference	Description	Part No.
GLP80	15.0 x 95mm – GLMI	TPH0946
GLP160	15.0 x 177mm – blue	TPH9961
GLP160	15.0 x 177mm EPDM Black	TPH9862
GLP80	20.4 x 95mm	TPH9839
GLP160	20.4 x 177mm – grey silicone	BB-10911
GLP160 (Driving)	32.0 x 180mm	TPH9821
GLM Series	Print Roller – blue segmented	TPH9918
GLME	20.0 x 174mm – grey silicone	BB-11005
	20 x 28mm Roller – blue	TPH9803



Felt 160 – TPH9765



Felt 104 – TPH9806

## PARTS FOR WEIGH LABELLING SYSTEMS







# **B&B FOODPAK**

## **Address**

Building 5  
49 Frenchs Forest Road East  
Frenchs Forest NSW 2086  
Australia

## **Phone & Fax**

Phone : 02 9452 0222

Fax : 02 9972 7901

## **Online**

Email : [admin@bbfoodpak.com](mailto:admin@bbfoodpak.com)

Website : [www.bbfoodpak.com](http://www.bbfoodpak.com)

